

BLE Heart Rate Strap

Compatibility

This Heart Rate Strap enables to track heart rate to compatible display device or Apps via Bluetooth Smart (Bluetooth 4.0) dual mode technology.

Item Check List

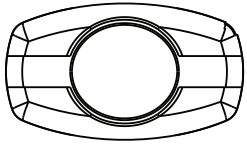

TX-F Dual Transmitter

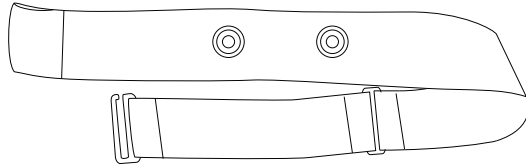

Fabric Chest Belt

Wearing Chest Belt For Heart Rate Function

The transmitter should be positioned in right below the breast/pectoral muscles. The strap should be comfortable, but secure. Note: Transmitter will automatically get into “wake up” mode, after the user wears it.

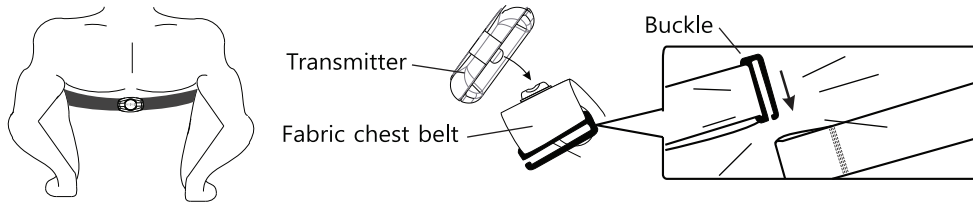

Wear the Heart Rate Strap

1. Adjust the strap length to a suitable personal length and and strong enough stay in place during your work out.
2. Buckle the sensor into place.
3. Wrap the strap around and below your chest, then clip the other end into place.
4. Make sure the logo is in upright position when you are wearing the strap.
5. If the devices doesn't receive signal from the sensor, wet both electrode areas on the back of the strap.

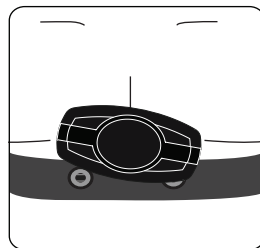
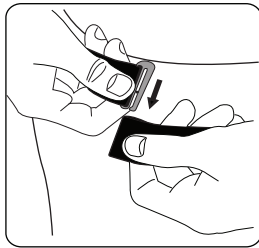
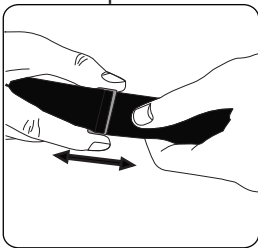

Care and Maintenance Instruction

1. Please store the strap and heart rate sensor separately when not in use and hold the plastic part to detach the sensor from the strap, don't pull the strap directly otherwise it could be damaged.
2. Keep both in cool and dry place. Store the strap lying flat or hanging loosely and do not fold from electrode areas of the strap for extended periods.
3. After every use, please detach the heart rate sensor from the strap and dry the heart rate sensor with the soft towel.
4. The strap should be rinsed under running water or washed in the washing machine within a laundry pouch. Please clean the strap gently and carefully. Use of detergents with optical brightening agents, moisturizing soaps or fabric softener is not recommended. Do not soak, iron, dry clean the strap or bend the electrode areas sharply.
5. Dry the strap with a soft towel after every wash and then hang to dry in a cool place. Do not expose the strap to direct sunlight.
6. The method of cleaning is determined by the symbols printed on the strap.

Battery Replacement

Step 1: Use a coin to twist it counter-clockwise to open.

Step 2: Remove the cover and insert (replace) the battery into the sensor with positive (+) side facing up. (Battery type: CR2032)

Note: Please be careful with the O-ring, losing the O-ring may cause water leakage.

Step 3: Place the battery cover. Use a coin to twist the cover clockwise to close.

